

FC EW 6 - 12mm Fibre Cement Sheet + 6mm Fibre Cement Wall Assembly

Assembly #	Stud Size (mm)	Steel			Exterior Cladding	Building Wrap	Interior Lining
		Thickness (mm)	Coating	Grade			
FC EW 6	75 to 100	0.75 to 2.00	Z180 to Z350	G350 to G550	FRAMECAD® 12mm Fibre Cement Sheet	FRAMECAD® Tuff Stuff Wrap	FRAMECAD® 6mm Fibre Cement Sheet

Framing and Wall Height

FRAMECAD® Stud width shall be 35mm minimum. Stud spacing shall be at 610mm centers maximum. Frame height as determined by specific design.

Cladding

One layer of FRAMECAD® 12mm Fibre Cement Sheet on the exterior side of FRAMECAD® cold formed steel wall frames.

Claddings are fixed a minimum of 50mm off the ground level unless a "Z" flashing is provided or as per local building regulations.

All Sheets to extend below the finished floor level by a minimum of 50mm.

Building Wrap

Install with a 150mm overlap between runs, with each higher run lapping over the layer below. Install external cladding without delay.

To be effective as a thermal insulator there must be a minimum air gap of 40mm adjacent to at least one reflective foil face.

Note: Aluminum foil is susceptible to alkali attack and therefore should not come in contact with wet concrete.

Lining

One layer of FRAMECAD® 6mm Fibre Cement Sheet on internal side of the FRAMECAD® cold formed steel wall frame.

Vertical fixing. Full height sheets shall be used where possible.

Horizontal fixing is permitted as long as all end sheet joints are formed over framing.

When sheet end butts joints are unavoidable, they shall be fixed at 200mm centres and formed over framing.

Linings are fixed 10mm off the floor.

Fastening
Cladding

FRAMECAD® 12mm Fibre Cement Sheet to be fixed using, 030149 FRAMECAD® X-Drive® 8g x 35mm Winged Drill Point screws at 300mm centers along sheet perimeter and centre studs. Fastening placement should be 12mm from sheet edge and 50mm from sheet corners. All end joints must be touch fitted.

Lining

FRAMECAD® 6mm Fibre Cement Sheet to be fixed using, 030149 FRAMECAD® X-Drive® 8g x 35mm Winged Drill Point screws at 300mm centres along sheet perimeter and centre studs. Fastening placement should be 12mm from sheet edge and 50mm from sheet corners. All end joints must be touch fitted.

Note: FRAMECAD® recommends a glue and screw method to ensure linings are affixed to wall, ceiling and floor frames. Glue dabs must be intermittent with a minimum distance of 100mm from fastening placement.

Jointing and Finishing

All screw / fastener heads should be covered with joint compound and all sheet joints to have reinforced tape and stopped / jointed in accordance with the stopping / jointing compound manufacturers recommendations.

Refer to the FRAMECAD® Fibre Cement Technical Guide for jointing and render finishing.

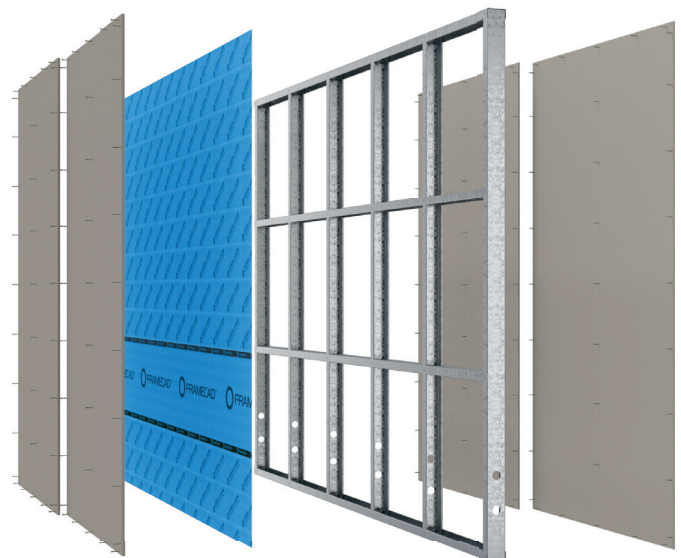

NOTE: In order for FRAMECAD® Wall Solutions to perform as designed all components must be installed exactly as prescribed. Substituting building components may produce an entirely different solution and may seriously compromise performance.

FC EW 6 - 12mm Fibre Cement Sheet + 6mm Fibre Cement Wall Assembly

FRAMECAD® Design and Build System encompasses a full range of building FRAMECAD® Sub-Assemblies that meet fire, thermal and acoustic values, or that are suitable for general lining and cladding. For details on the appropriate assembly for your project please contact us. www.framecad.com

DISCLAIMER:

This document is current as at July 2015 and supersedes all previous versions of the FRAMECAD® FC EW 6.

The material in this document is provided for general information purposes only.

Although all reasonable efforts have been made to ensure that the information is current, relevant and accurate as at the date of issue, the information provided is selective and may not be complete or suitable for your intended use or jurisdiction.

No information in this document constitutes, or shall be relied upon as constituting, the giving of advice of any nature. Nor is any such information to be used as a substitute for (1) specific advice from appropriate independent professional advisors in your jurisdiction regarding your particular facts and circumstances or (2) compliance with the requirements of applicable regulatory authorities, standards, regulations, laws, or building codes.

You should not act (or refrain from acting) based upon information provided by FRAMECAD® without independently verifying the original source information and, making your own independent assessment, with the assistance of appropriate independent professional advisors, regarding your particular facts and circumstances.

FRAMECAD® makes no representation or warranty, express or implied, as to the accuracy, completeness or suitability for purpose, of any information in this document.

To the extent permitted by law, FRAMECAD® accepts no responsibility to the recipient or any other person for any loss, damage, cost or expense (whether direct or indirect and however caused, including by negligence) incurred and arising out of or in connection with any use or reliance by any of them on the information in this document including, but not limited to, as a result of any error, omission or misrepresentation in any information or statement in this document. This limitation of liability includes but is not limited to incidental, special or consequential damages, damages for loss of business or other profits. Liability which cannot legally be excluded is limited to the maximum extent possible."

Any reproduction or dissemination of all or any part of this document is prohibited, except with the prior written consent of FRAMECAD® Ltd.